

XTOOL | M1 Ultra

快速使用指南



物料清单 ----- **01**

认识 xTool M1 Ultra ----- **02**

使用前准备 ----- **04**

使用 xTool M1 Ultra ----- **08**

指示灯说明 ----- **16**

物料清单

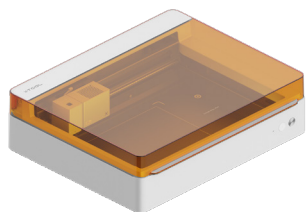

01 xTool M1 Ultra



02 激光器

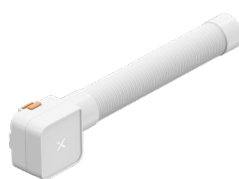

03 排烟模块



04 USB 线



05 电源适配器和电源线



06 细切刀



07 针管笔



08 笔套

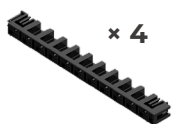

09 三棱条支架

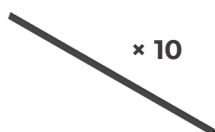

10 三棱条

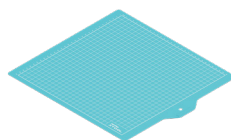

11 低粘垫板

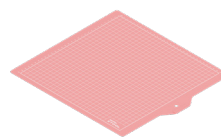

12 织物垫板



13 滤棉



14 钥匙



15 润滑脂

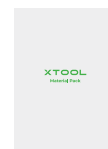

16 耗材包



17 镜片座 (备用件)



18 镜片座旋转片



19 螺丝刀



20 多功能托架



21 裁切刀



22 底板手拧螺丝 (备用)



23 快速指南



24 安全说明

认识 xTool M1 Ultra

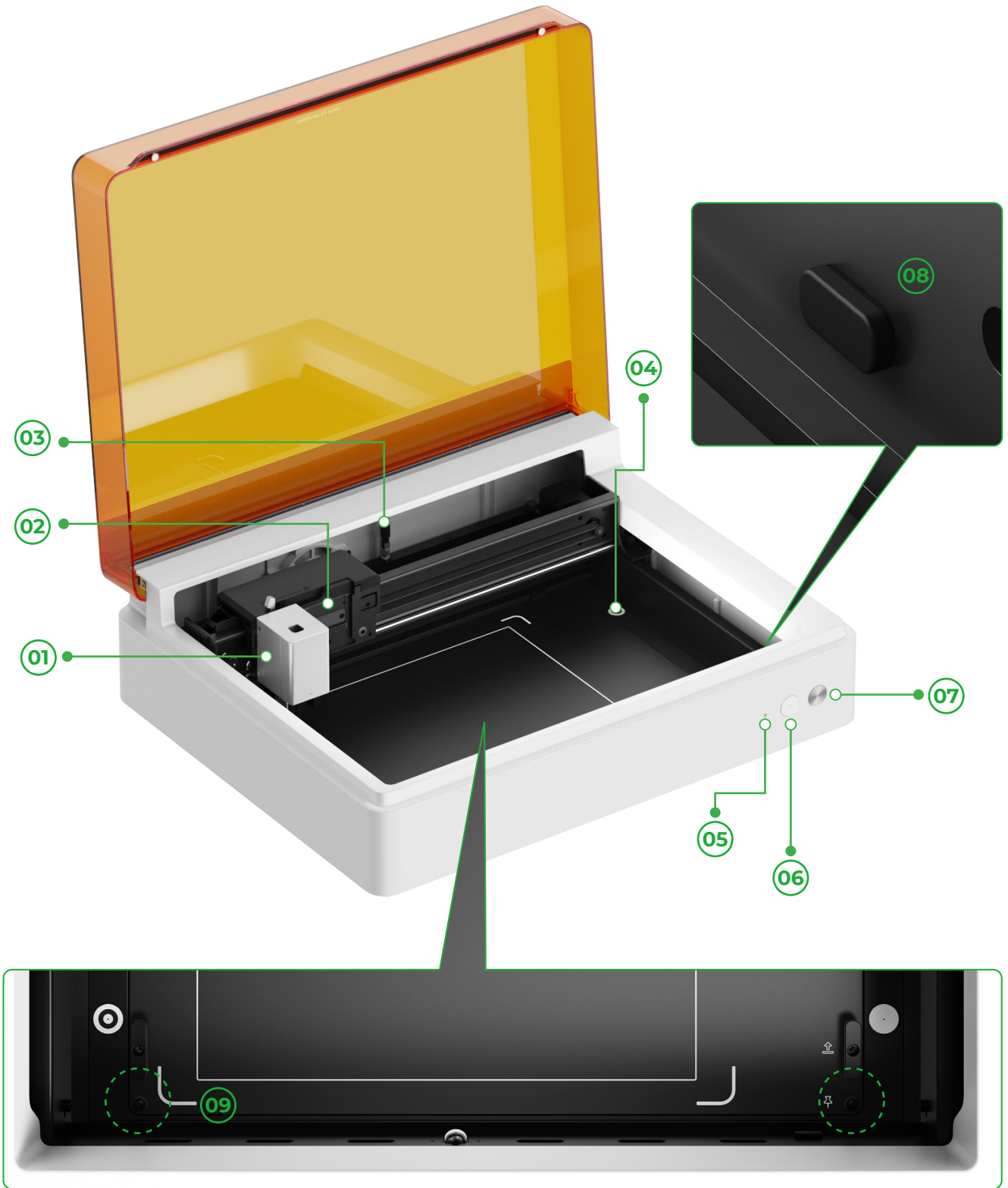

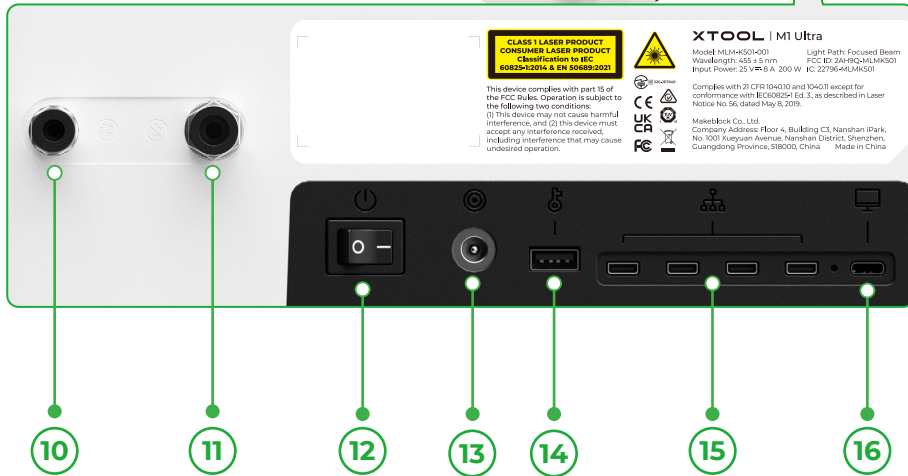
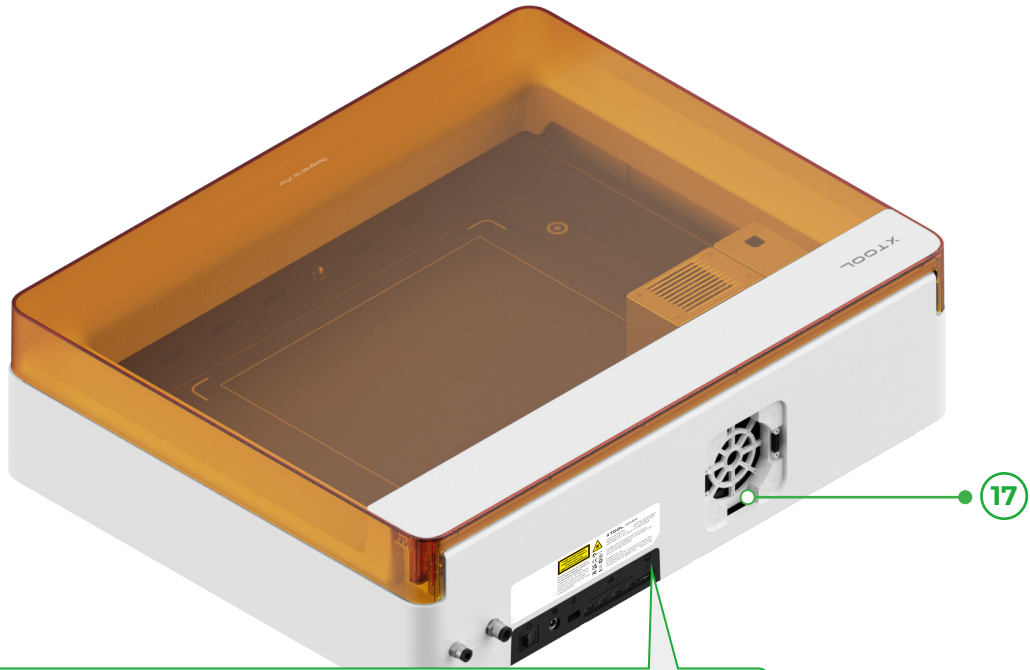

01 基础托架

02 多功能支架

03 Wi-Fi 天线

04 拍照定位点

05 指示灯

06 取点按钮

07 开始 / 停止按钮

08 旋转附件接口

09 底板手拧螺丝

10 空气辅助装置气管接口

11 火焰安全装置气管接口

12 电源开关

13 电源接口

14 钥匙插口

15 扩展配件接口 × 4

16 USB 接口

17 排烟口

使用前准备

1 拆下固定在 x 轴和 y 轴导轨上的螺丝

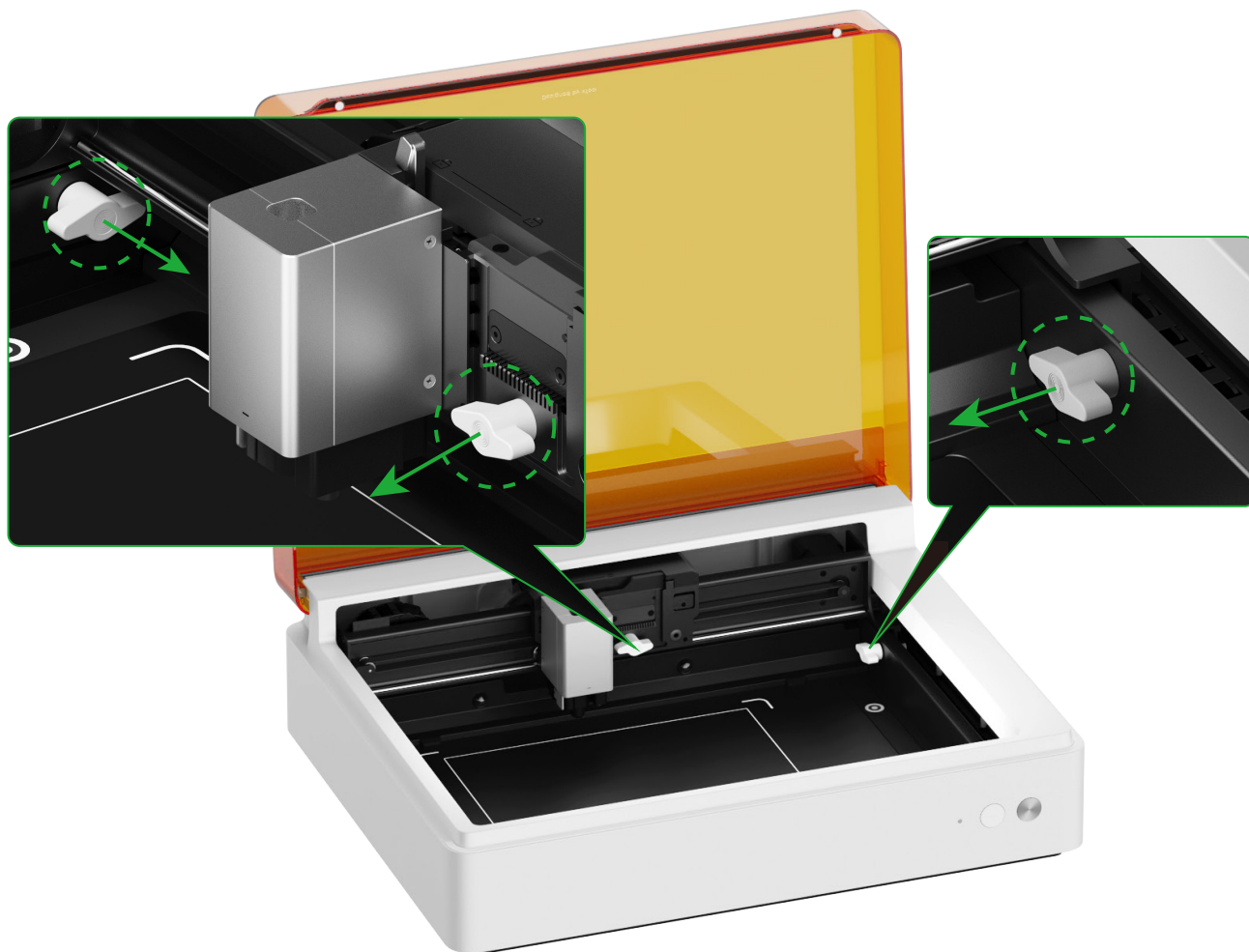

2 安装激光器

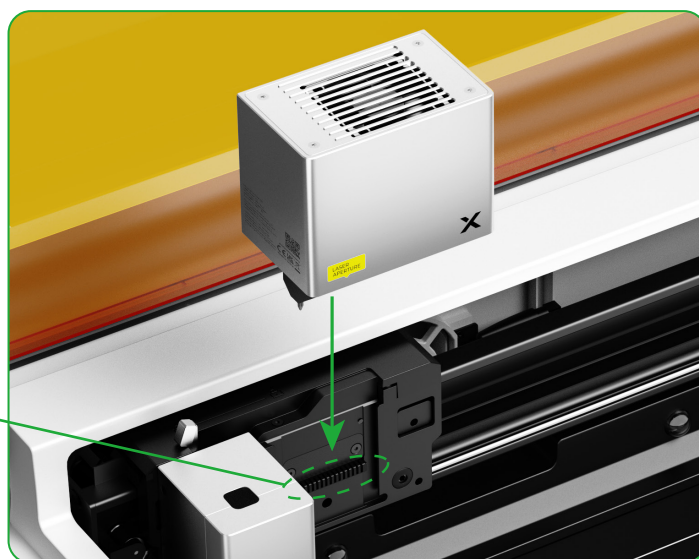
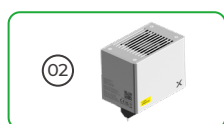

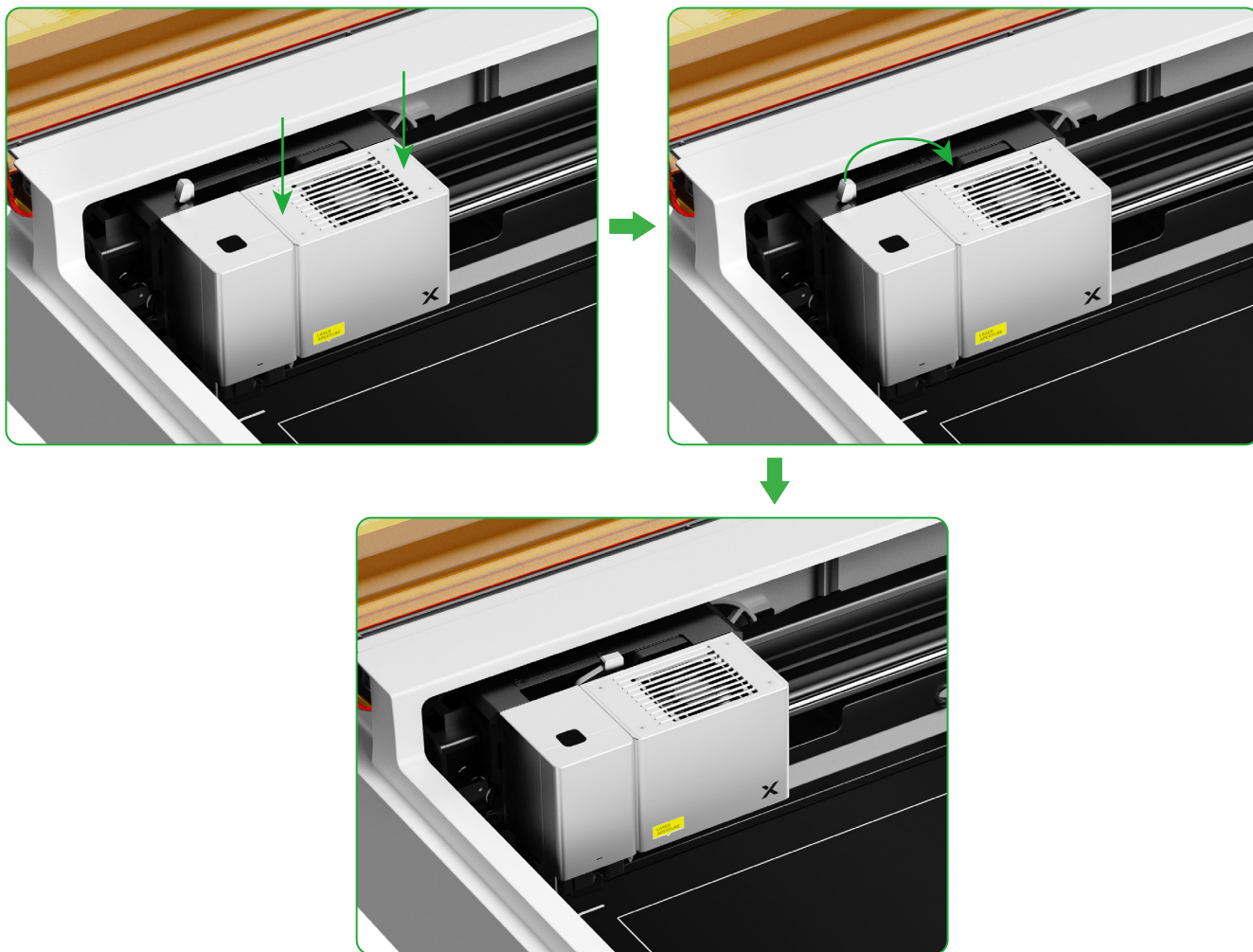

3 安装排烟模块

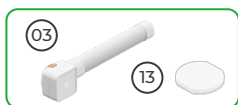

使用排烟模块前请先安装滤棉。排烟模块未安装滤棉使用容易吸附烟尘造成损坏。

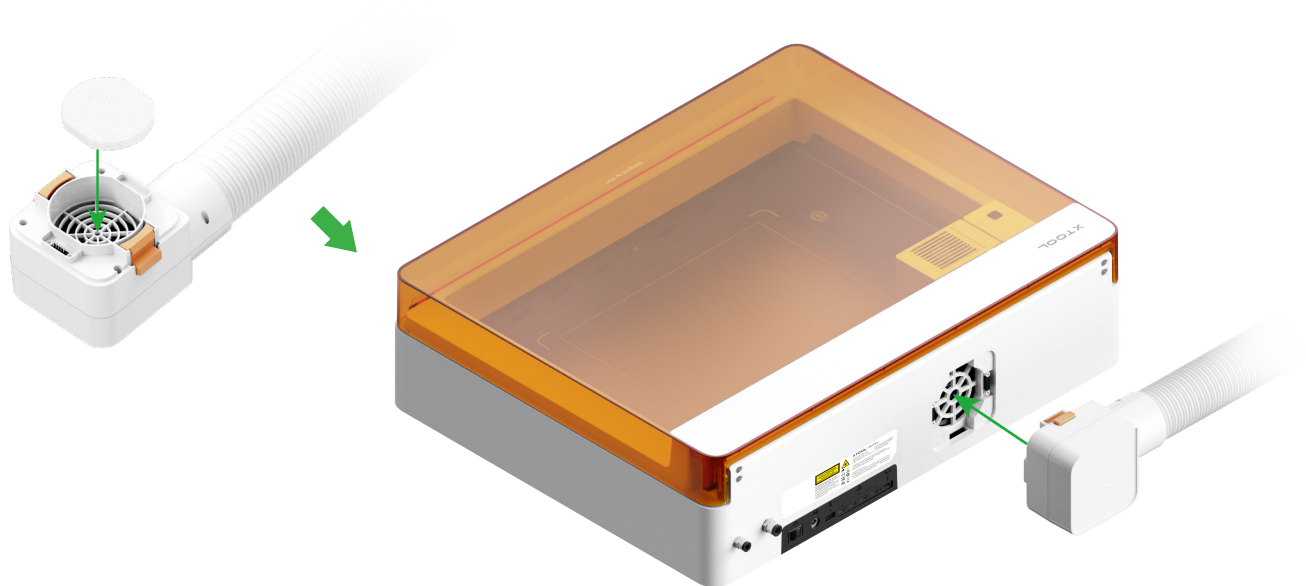

4 插入钥匙

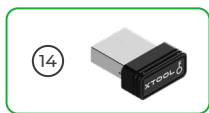

- 插上钥匙即可解锁机器的加工及其相关功能。
- 拔掉即可锁定加工及其相关功能。

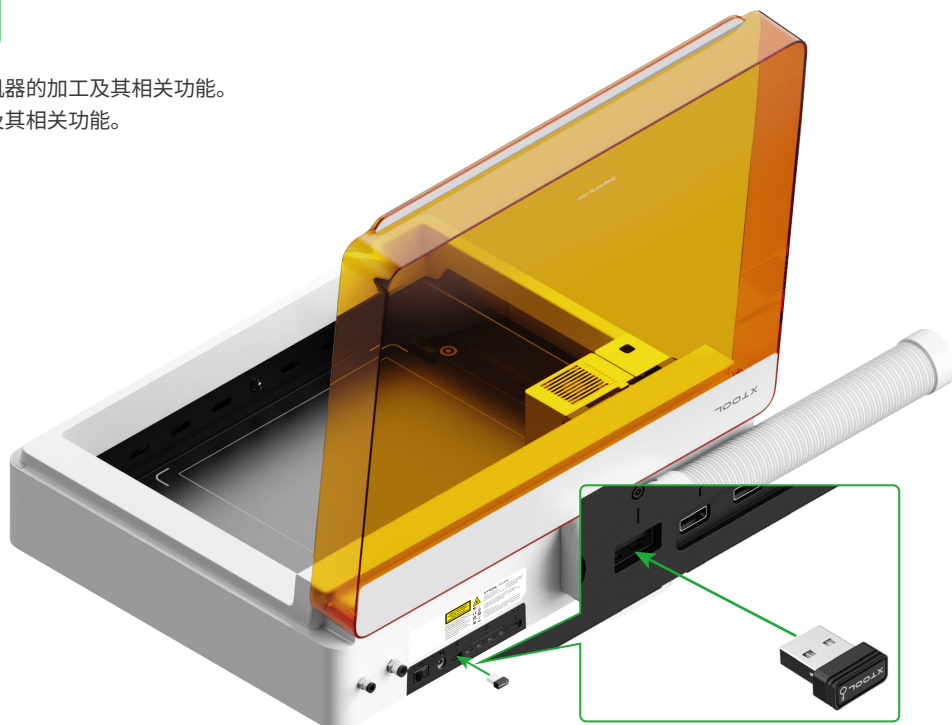

5 接通电源

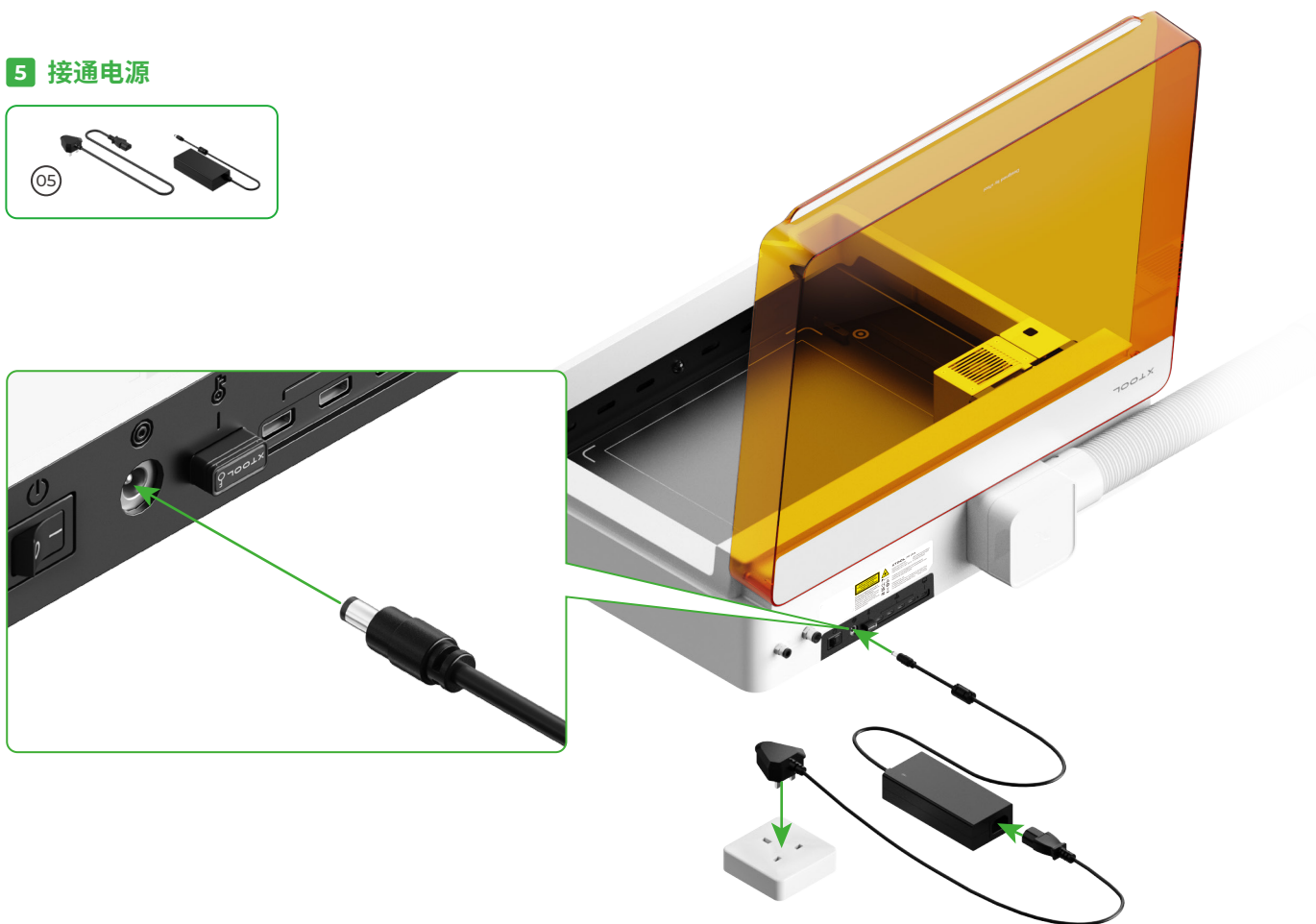
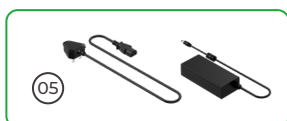

6 下载并安装 XCS 软件

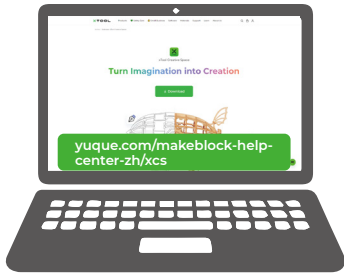

请访问 yuque.com/makeblock-help-center-zh/xcs 下载并安装 xTool 官方软件 XCS (xTool Creative Space)。

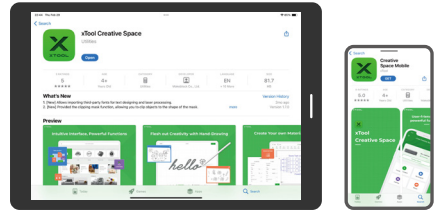

请访问 yuque.com/makeblock-help-center-zh/xcs-2.x 下载并安装 App。

7 连接 xTool M1 Ultra 至电脑

- 打开 xTool M1 Ultra 的电源开关, 连接设备, 然后在 XCS 软件中连接 xTool M1 Ultra。

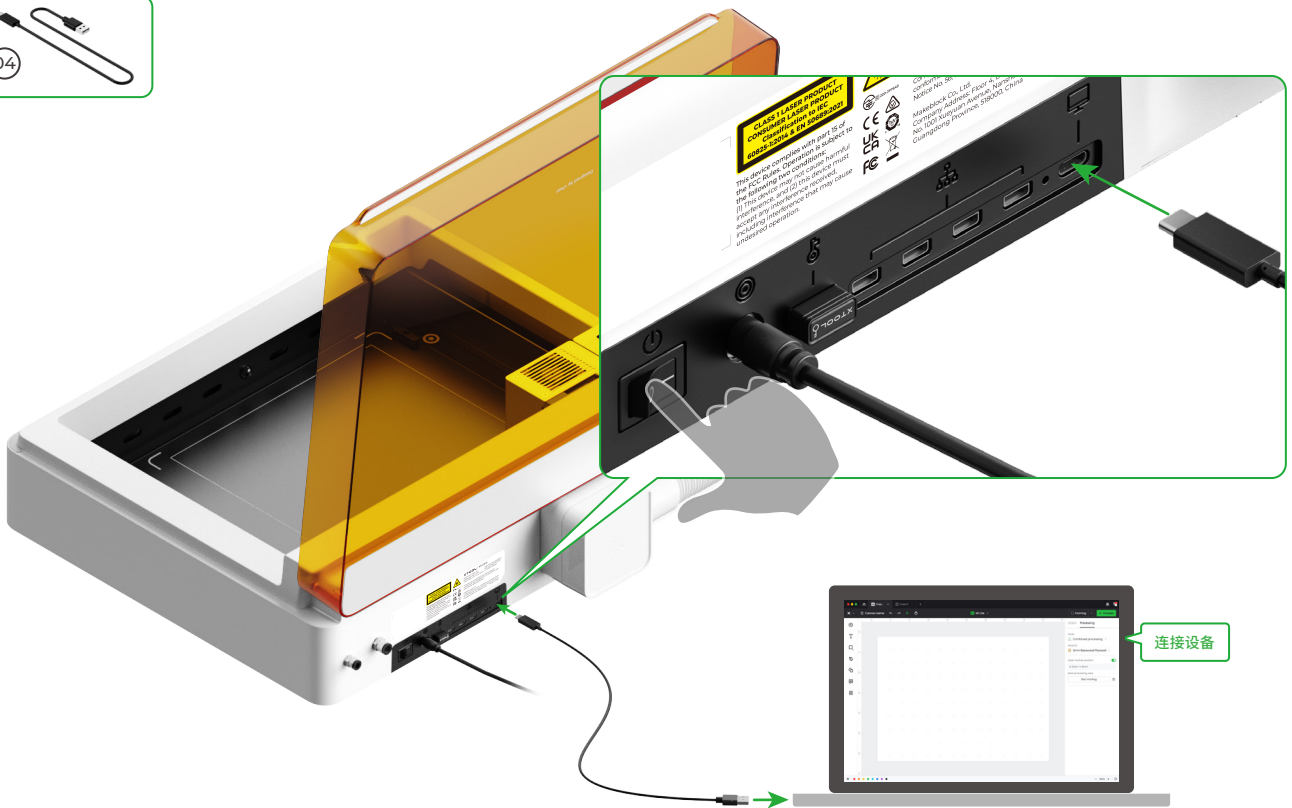
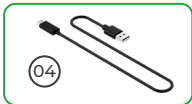

- 如需了解更多如何使用 xTool M1 Ultra 操作 XCS 软件进行加工, 扫描以下二维码或前往 yuque.com/makeblock-help-center-zh/xtool-m1-ultra。



使用 xTool M1 Ultra

使用激光器进行切割加工时

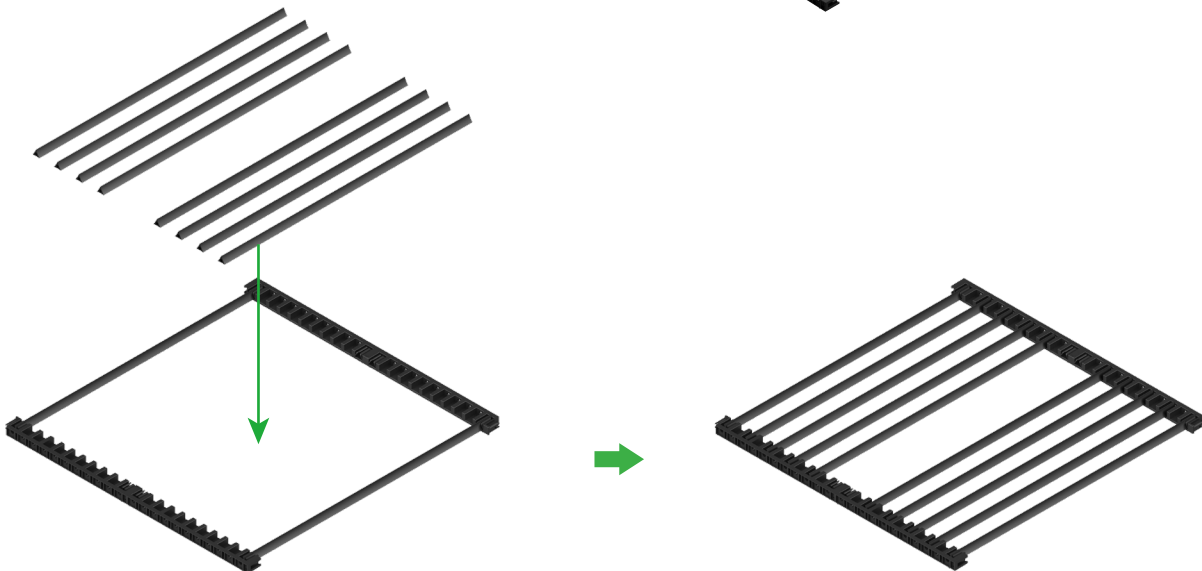
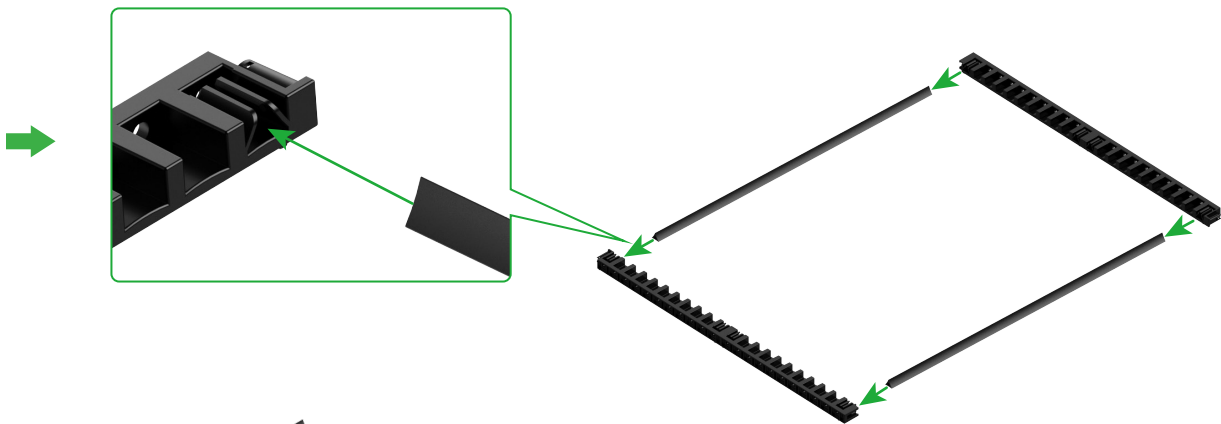
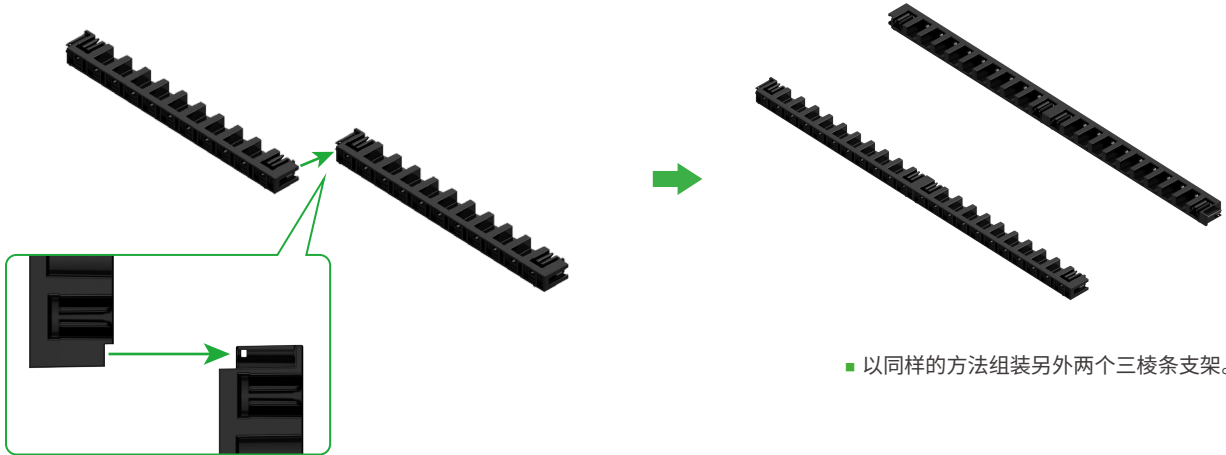
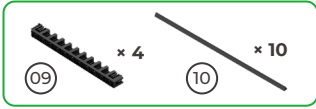

■ 根据加工材料调整三棱条的使用数量。

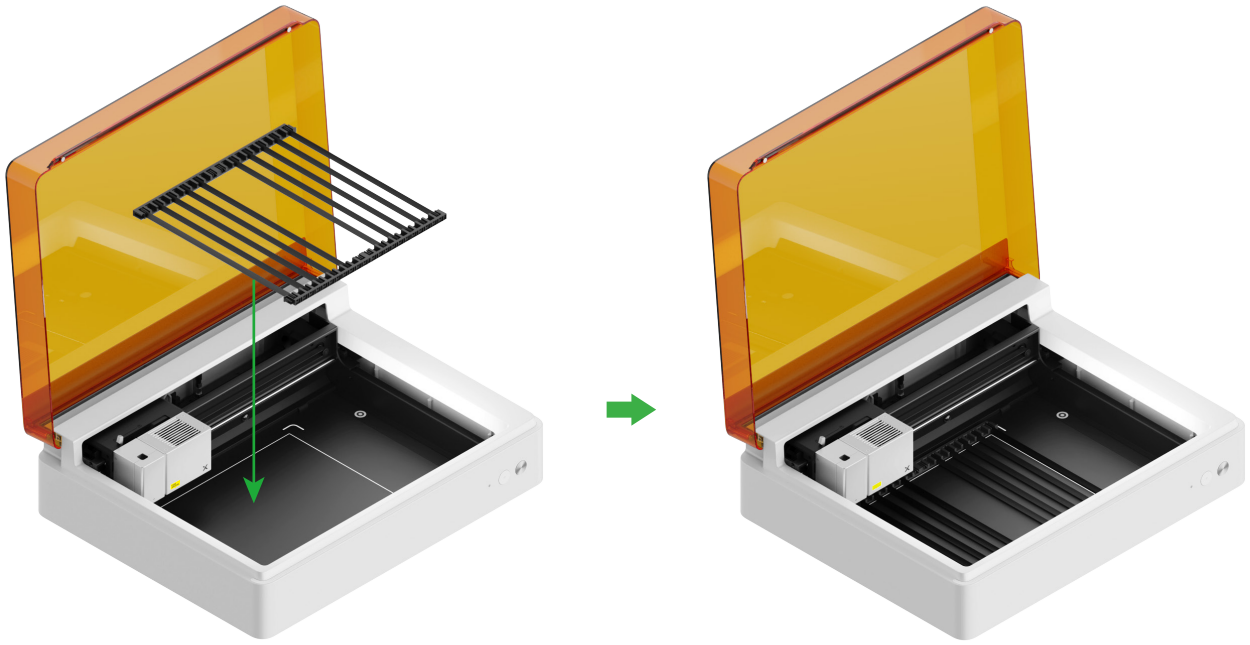

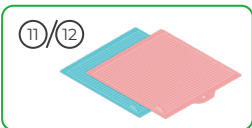

使用刀切加工或激光器和刀切组合加工时

(1) 放置垫板



注意：如使用卡纸、牛皮纸等纸质材料，请使用低粘垫板；如使用布料等织物，则请使用织物垫板。
使用激光器进行切割加工时，请勿使用垫板。

垫板		
颜色	蓝色	粉色
适用于	轻薄材料	织物
材料	卡纸，包装纸，印刷纸，牛皮纸，珠光纸	织物

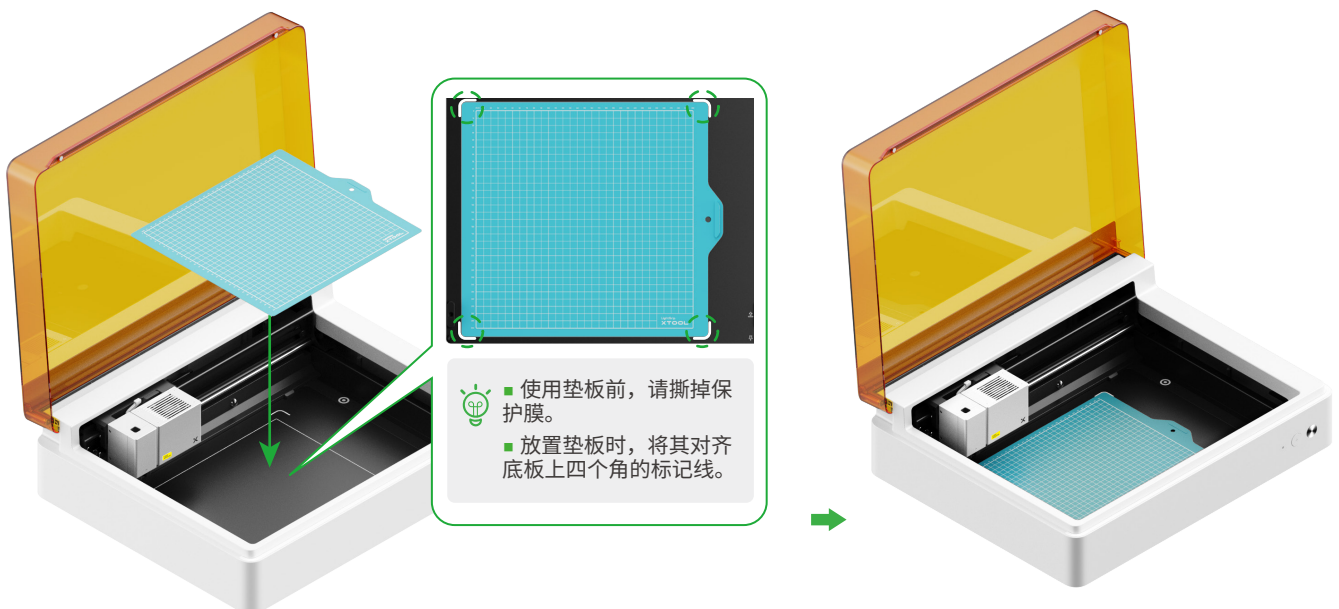

(2) 安装细切刀

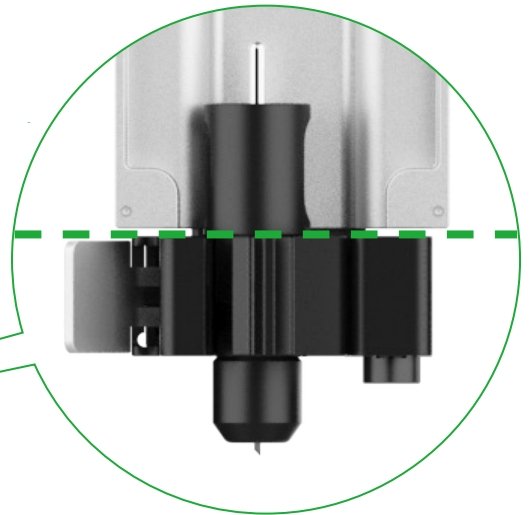
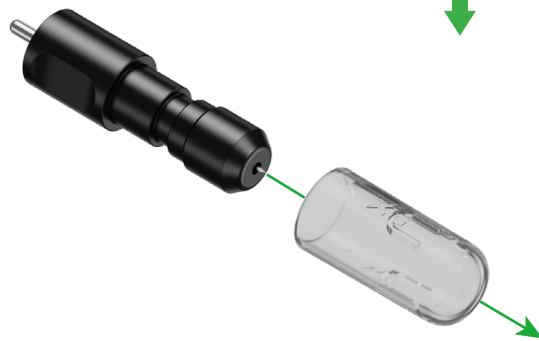
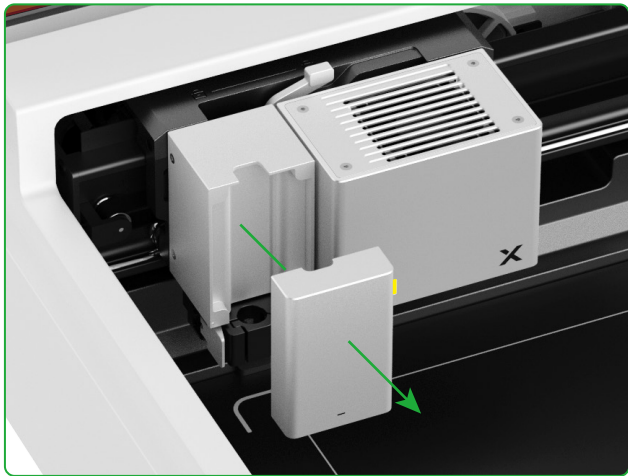

警告！
刀头锋利

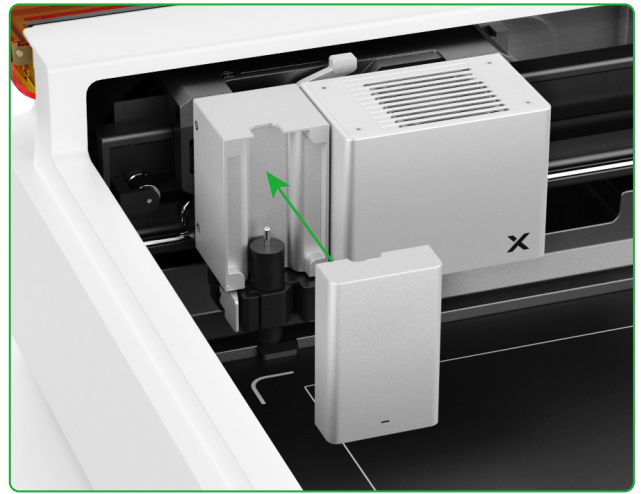
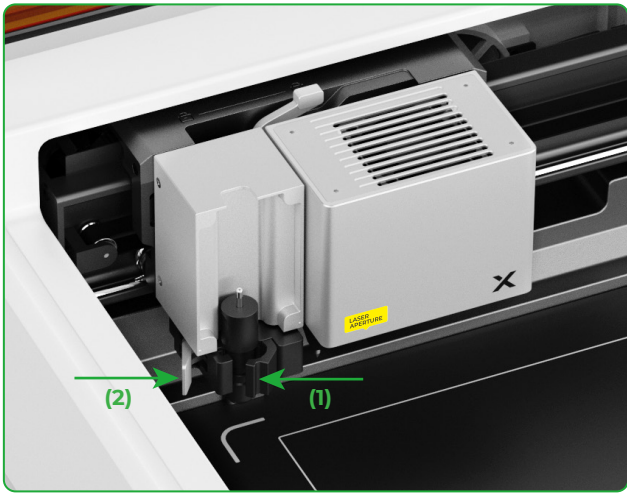

使用画笔加工时

(1) 将针管笔安装到笔套上

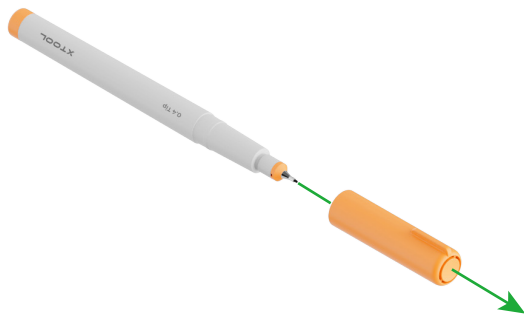

(2) 安装针管笔

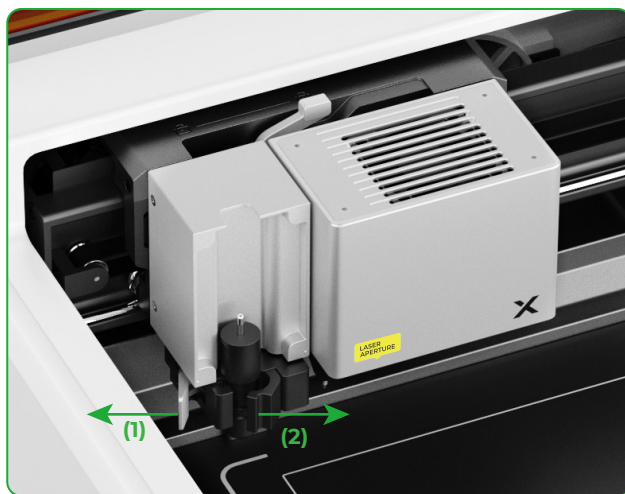
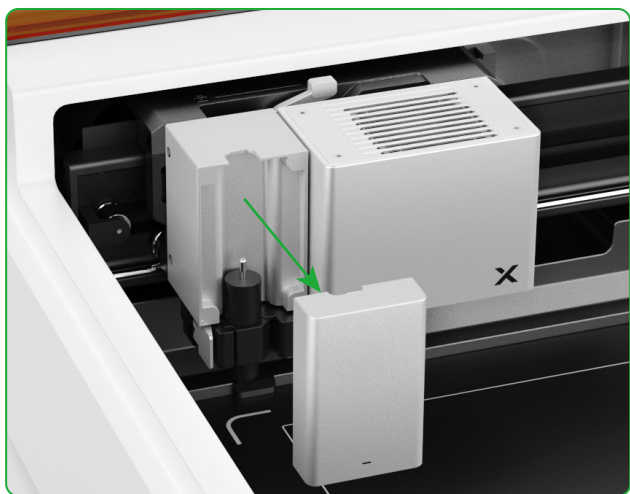

警告！
刀头锋利

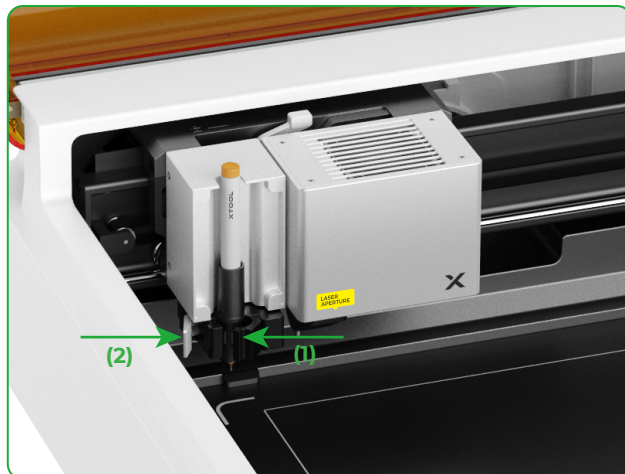
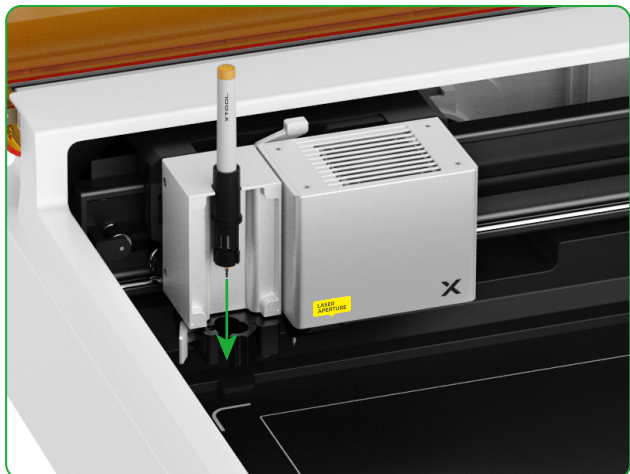
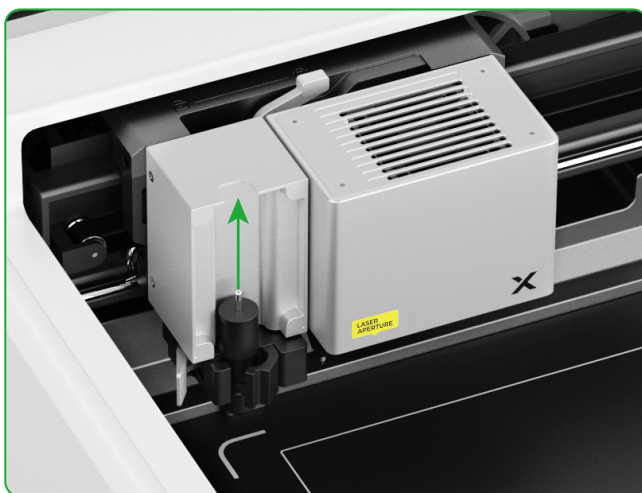

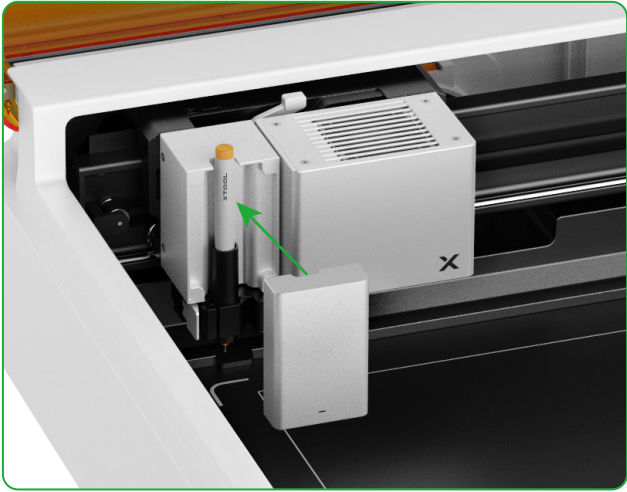

使用更多功能加工时

(1)

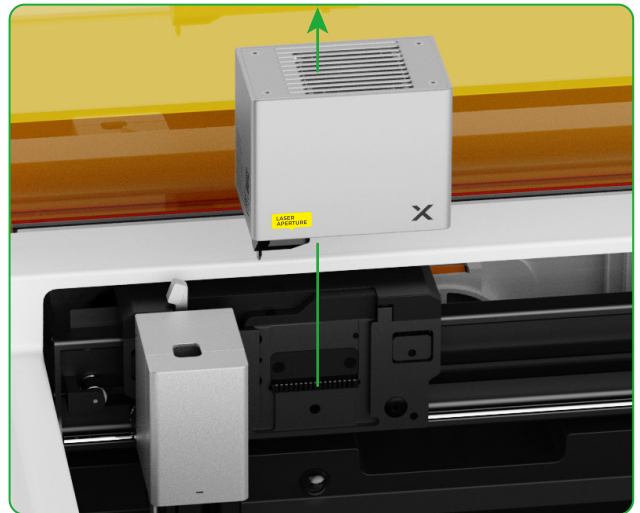
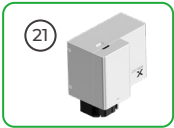

(2) 将相应配件安装到多功能托架上

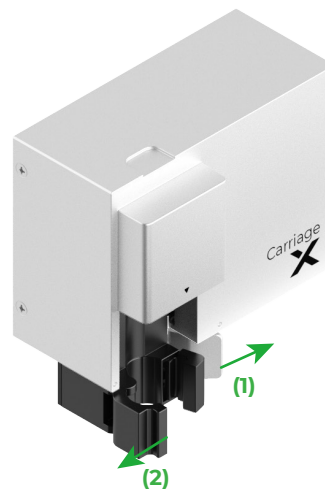
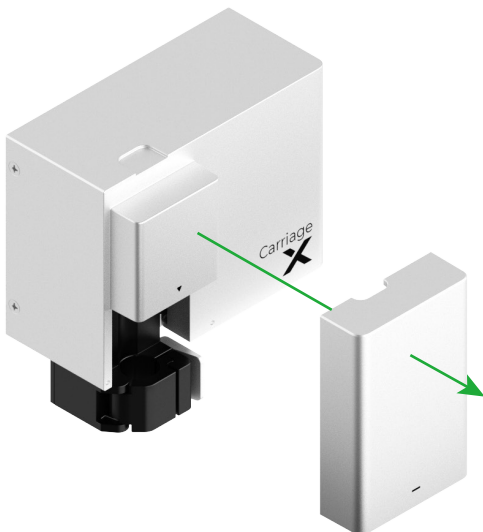



根据加工需要选择相应的配件。

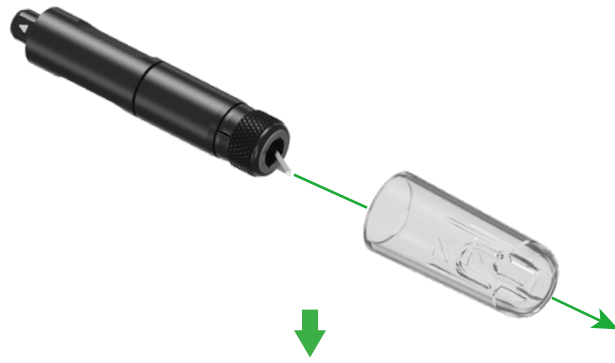

警告！
刀头锋利

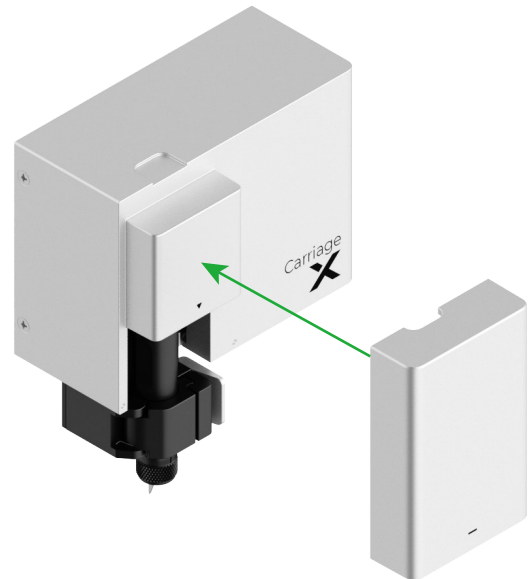
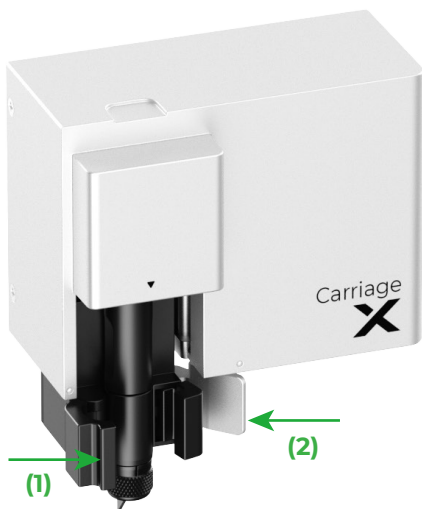
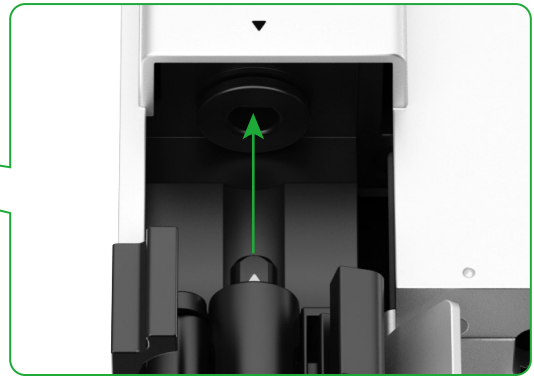

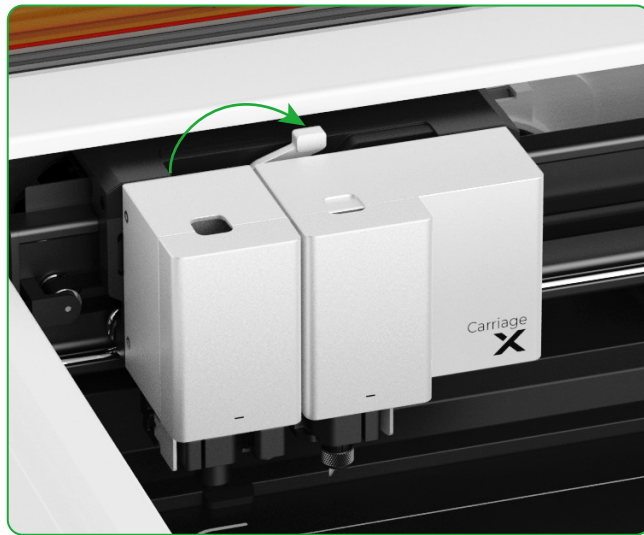
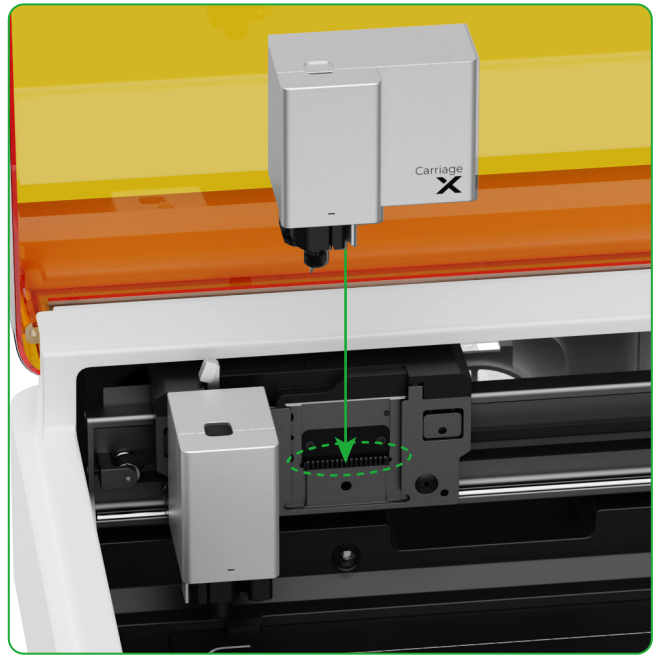

指示灯说明

指示灯状态	蜂鸣器状态	设备状态
 白色常亮	/	未连接软件, 待机 (AP 模式)
 浅蓝色常亮	/	未连接软件, 待机 (STA 模式)
 紫色常亮	响 1 次	已连接软件, 待机
 白色呼吸	/	未连接软件, 休眠
 紫色呼吸	/	已连接软件, 休眠
 紫色慢闪	/	固件升级
 绿色常亮	/	在软件上标定加工区域 / 走边框中 / 加工中
 蓝色慢闪	响 1 次	走边框准备就绪 / 加工就绪
 蓝色常亮	/	加工暂停
 黄色闪烁	响 1 次	加工过程中, 盖子被打开或未完全关闭
 黄色闪烁	持续响起	检测到火焰 (火焰较小) / 设备震动
 红色闪烁	持续响起	检测到火焰 (火焰稍大)
 黄色闪烁	响 3 次	设备异常
 红色闪烁	响 3 次	设备较大异常

XTOOL